





## Rohrbögen 90° Bauart 3





## EN 10253 Typ A (DIN 2605)

Fortsetzung  
von Vorseite

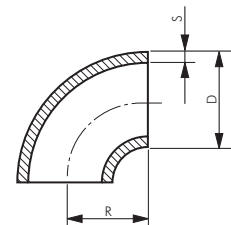
Typ 1.4571* 	Typ 1.4541 	Typ 1.4571* 	Typ 1.4541 	Typ P235GH-TC1 Stahl schwarz	Anschluss D x S R		
geschweißte Ausführung		nahtlose Ausführung					
W76,120GA6	W76,120GA4	W76,120A6	---	---	76,1 x 2,0	95,0	
W76,126GA6	W76,126GA4	W76,126A6	W76,126A4	---	x 2,6	95,0	
W76,129GA6	W76,129GA4	W76,129A6	W76,129A4	W76,129ST	x 2,9	95,0	
W76,136GA6	W76,136GA4	W76,136A6	W76,136A4	W76,136ST	x 3,6	95,0	
---	---	W76,140A6	W76,140A4	W76,140ST	x 4,0	95,0	
---	---	W76,150A6	W76,150A4	W76,150ST	x 5,0	95,0	
W88,920GA6	W88,920GA4	---	---	---	88,9 x 2,0	114,0	
W88,923GA6	W88,923GA4	---	---	---	x 2,3	114,0	
W88,926GA6	W88,926GA4	W88,926A6	W88,926A4	---	x 2,6	114,0	
W88,929GA6	W88,929GA4	W88,929A6	W88,929A4	---	x 2,9	114,0	
W88,932GA6	W88,932GA4	W88,932A6	W88,932A4	W88,932ST	x 3,2	114,0	
W88,940GA6	W88,940GA4	W88,940A6	W88,940A4	W88,940ST	x 4,0	114,0	
W101,630GA6	---	---	---	---	101,6 x 3,0	133,5	
W10420GA6	W10420GA4	---	---	---	104,0 x 2,0	150,0	
W10820GA6	W10820GA4	---	---	---	108,0 x 2,0	142,5	
W10830GA6	W10830GA4	W10830A6	W10830A4	---	x 3,0	142,5	
W114,320GA6	W114,320GA4	---	---	---	114,3 x 2,0	152,0	
W114,326GA6	W114,326GA4	W114,326A6	W114,326A4	---	x 2,6	152,0	
W114,330GA6	W114,330GA4	---	---	---	x 3,0	152,0	
W114,336GA6	W114,336GA4	W114,336A6	W114,336A4	W114,336ST	x 3,6	152,0	
W114,340GA6	W114,340GA4	---	---	W114,340ST	x 4,0	152,0	
---	---	W114,345A6	W114,345A4	W114,345ST	x 4,5	152,0	
W12920GA6	W12920GA4	---	---	---	129,0 x 2,0	187,5	
W13330GA6	W13330GA4	---	---	---	133,0 x 3,0	181,0	
---	---	W13340A6	W13340A4	W13340ST	x 4,0	181,0	
W139,720GA6	W139,720GA4	---	---	---	139,7 x 2,0	190,0	
W139,726GA6	W139,726GA4	---	---	---	x 2,6	190,0	
W139,730GA6	W139,730GA4	---	---	---	x 3,0	190,0	
W139,740GA6	W139,740GA4	W139,740A6	W139,740A4	W139,740ST	x 4,0	190,0	
W15420GA6	W15420GA4	---	---	---	154,0 x 2,0	225,0	
W15930GA6	W15930GA4	---	---	---	159,0 x 3,0	216,0	
W168,320GA6	W168,320GA4	---	---	---	168,3 x 2,0	229,0	
W168,326GA6	W168,326GA4	---	---	---	x 2,6	229,0	
W168,330GA6	W168,330GA4	---	---	---	x 3,0	229,0	
W168,340GA6	W168,340GA4	---	---	---	x 4,0	229,0	
---	---	W168,345A6	W168,345A4	W168,345ST	x 4,5	229,0	
W20420GA6	---	---	---	---	204,0 x 2,0	300,0	
W219,120GA6	W219,120GA4	---	---	---	219,1 x 2,0	305,0	
W219,126GA6	---	---	---	---	x 2,6	305,0	
W219,130GA6	W219,130GA4	---	---	---	x 3,0	305,0	
W25420GA6	W25420GA4	---	---	---	254,0 x 2,0	375,0	
W27330GA6	W27330GA4	---	---	---	273,0 x 3,0	381,0	
W323,930GA6	W323,930GA4	---	---	---	323,9 x 3,0	457,0	
W355,630GA6	W355,630GA4	---	---	---	355,6 x 3,0	533,0	
W406,430GA6	W406,430GA4	---	---	---	406,4 x 3,0	610,0	

\* Standardlieferprogramm



 Absperrventile auf Seite 446	 fischer Installationssysteme ab Seite 1023	 Rohrschellen ab Seite 362	 Edelstahl-Kugelhähne mit Anschweißenden ab Seite 437
 Pressittings ab Seite 110	 Kamlock-Kupplungen ab Seite 290	 Chemie- Schläuche ab Seite 342	
 Flansch-Kugelhähne ab Seite 456	 Klappenventile ab Seite 475	 Bürsten ab Seite 880	 Flansche ab Seite 382

Alle Angaben verstehen sich als unverbindliche Richtwerte! Für nicht schriftlich bestätigte Datenauswahl übernehmen wir keine Haftung. Druckangaben beziehen sich, soweit nicht anders angegeben, auf Flüssigkeiten der Gruppe II bei +20°C.